

INSPECTION

1. REMOVE THROTTLE BODY COVER
2. REMOVE INTAKE AIR CONNECTOR
3. REMOVE INTAKE MANIFOLDS ASSEMBLY

(See page [EM-36](#))

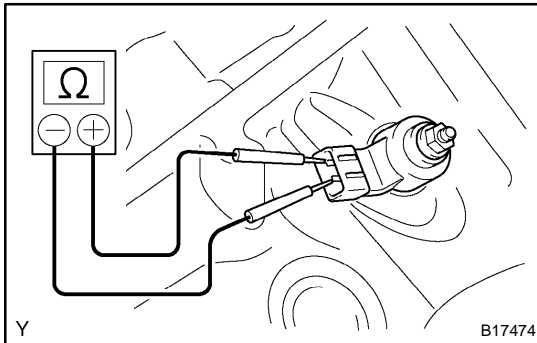

4. INSPECT KNOCK SENSORS 1 AND 2

- (a) Disconnect the knock sensor connectors.
- (b) Using an ohmmeter, measure the resistance between terminals.

Resistance: 120 to 280 k Ω at 20°C (68°F)

HINT:

If the resistance is not as specified, replace the sensor.

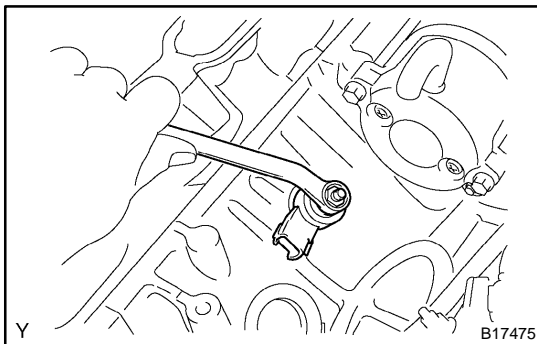

5. REMOVE KNOCK SENSOR

- (a) Disconnect the 2 knock sensor connectors.
- (b) Remove the 2 nuts and 2 knock sensors.

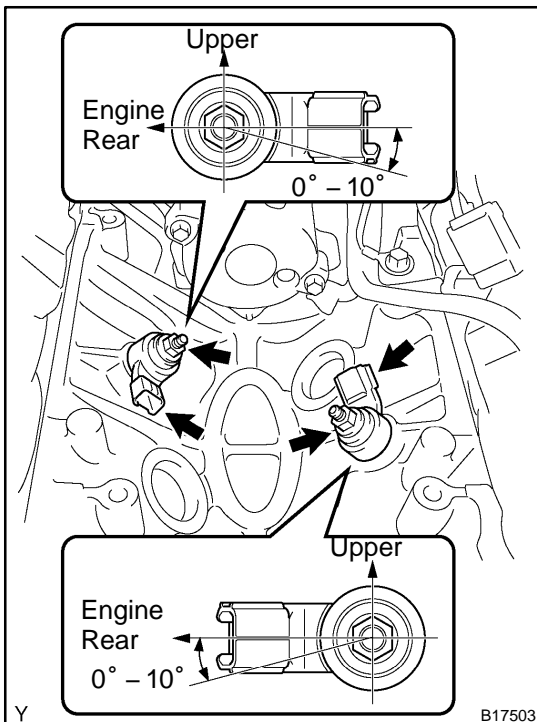

6. INSTALL KNOCK SENSOR

- (a) Install the 2 knock sensors with the 2 nuts as shown in the illustration.

Torque: 20 N·m (204 kgf·cm, 15 ft·lbf)

- (b) Connect the 2 knock sensor connectors.

7. INSTALL INTAKE MANIFOLD ASSEMBLY

(See page [EM-60](#))

8. INSTALL INTAKE AIR CONNECTOR

9. INSTALL THROTTLE BODY COVER